



Model Name		ROOM MONITOR	DOOR STATION
Model No.		VL-MC3035BX & VL-MC3035WX	VL-VC3535BX
Product Image & Colours			
System Parameters	Operation System	Linux	Linux
	Flash	128 MB	16 MB
	RAM	64 MB	64 MB
	Storage (MicroSD Card)	32 MB (Included)	—
Display Parameters	Size	7-inch wide colour display	—
	Operation Method	Capacitive touch screen	Mechanical Keys
	Display Resolution	1024 x 600	—
	Video Codec	H.264 & H.265	H.264
Video Parameters	Video Resolution	VGA, 720P	VGA, 720P
	Camera Pixel	—	2.0M pixels CMOS sensor
	Minimum Illuminance	—	0.01lx (within approx. 50cm from the camera)
	Camera Quantity	—	Single Camera
	Viewing Angle	—	78° (H)/ 58°(V)
	Lighting Method	—	White coloured LED lights
Audio Parameters	Audio Compression	G.711	G.711
	Speaker	8Ω / 0.5W	8Ω / 0.5W
	Microphone	-56 ± 2dB	-56 ± 2dB
Network Parameters	Wi-Fi	Supported (WLAN 2.4GHz)	—
	Wiring	UTP (Cat 5e or higher)	UTP (Cat 5e or higher)
	Protocol	IPv4; TCP/IP; ICMP; UDP; RTSP; HTTP; DNS; RTP; RTMP; ARP; NTP	IPv4; TCP/IP; ICMP; UDP; RTSP; HTTP; DNS; RTP; RTMP; ARP; NTP
Device Parameters	Network Interface	RJ45, 10BASE-T/100BASE-TX (Auto MDI/MDI-X)	RJ45, 10BASE-T/100BASE-TX (Auto MDI/MDI-X)
	Power Out Port	12V, 200mA max	—
	Doorbell Port	1	—
	Lock Release	—	1 (Relay required)
	Door Status Port	—	1
Capacity	Linked IP Camera	6 (Private IPC)	—
	Voice Messages	10	—
	Intercom Logs	100	—
	Alarm Logs	100	—
	Recording	100 *With MircoSD card (video with audio)	—
General	Power Source	PoE (IEEE 802.3af compliant, Class 0 device) or Power supply unit (Sold separately)	PoE Splitter or Power supply unit (Sold separately)
	Operating Voltage	PoE 48V or 12 to 27VDC	12 to 27VDC
	Current Rating	POE 48V, 160mA or DC 12V, 630mA; or DC 27V, 280mA	DC 12V, 500mA; DC 27V, 250mA
	Power Consumption	Standby: 2.7W, Operating: 3.8W (excluding power out)	Standby: 3.0W, Operating: 6.0W
	Installation Method	Surface mount with magnet	Flush mount
	Colour	Black / White	Black
	Dimensions (H x W x D) (Excluding protruding sections)	Approx. 130mm x 194mm x 15.9mm	Approx. 168mm x 93mm x 32mm
	Operating Temperature	-25°C to +50°C	-20°C to +60°C
	Storage Temperature	-40°C to +70°C	-40°C to +70°C
	Operating Humidity	Up to 90% (non-condensing)	Up to 90% (non-condensing)
	IP rating (Ingress Protection)	IP30	IP54
	IK rating (Impact Protection)	—	IK04
	Talking Method	Hands-Free	Hands-Free
	Display Language	English, Chinese, Vietnamese, Indonesian and Thai	—
	Casing Material	PMMA + ABS	AL + Tempered glass
	Weight	Without package: 330g   With package: 510g	Without package: 350g   With package: 560g

**Trademarks and registered trademarks**

- Apple, the Apple logo, Iphone and Ipad are trademarks of Apple Inc., registered in the U.S and other countries.
- App Store is a service mark of Apple Inc., registered in the U.S and other countries.
- Android, Google Play, and the Google Play logo are trademarks of Google LLC.
- The software of these products are based in part on the work of the independent JPEG Group.
- S.I.CITY is trademark of Panasonic Appliances R&D Center Singapore, registered in Singapore and other countries.
- All other trademarks identified herein are the property of their respective owners.

**Important**

- Safety Precaution: Carefully read the operating instructions and installation manual before using these products.
- Panasonic cannot be responsible for the performance of the network and/ or other manufacturers' products use on the network.
- This system is not designed to provide complete protection from property loss. To the maximum extent permitted by applicable law, Panasonic will not be held responsible for any damage incurred as a result of property loss.
- When installing or using the product, please take into consideration the rights of others with regards to privacy and rights of portrait.
- This catalog is provided for many countries. Please note that some products may not be available in some countries.
- Actual products may vary slightly from photographs.
- Weights and dimensions are approximate.
- Design and Specifications are subject to change without notice.
- These products may be subject to export control regulations.

DISTRIBUTED BY:

**Panasonic**

**Panasonic**

# Safe, Secure & Convenient Living

VIDEO INTERCOM SOLUTIONS FOR MODERN LIVING



ROOM MONITOR

DOOR STATION

## INTRODUCING PANASONIC'S SINGLE HOUSE VIDEO INTERCOM SYSTEM.

Elevate Your Home Security with Advanced Technology and Seamless Connectivity with the video intercom system that comes with mobile application, stay connected to visitors calls even when you're away for ultimate ease and peace of mind. Connectivity at your fingertips right here at home and away.

### ROOM MONITOR VL-MC3035BX & VL-MC3035WX



#### Supported Functions

- Video intercom: Video & Audio communication
- Remote unlock: Unlock e-lock connected to Door Stations and open door remotely.
- Voice message: Listen to audio messages left by visitors.
- Surveillance: Monitor Door Stations and IP CCTV cameras within the same network.
- Device Removal Alarm: When device is removed, alarm will be sounded, and alert will be sent.
- SOS/Duress: Send SOS alert to Mobile Apps.
- Intercom log: Supports logging of call history.
- Video Recording: Automatic Video and Audio recording during calls (with MicroSD Card).
- Voice Changer: Transform female to male voice in a real-time call.

### DOOR STATION VL-VC3535BX



#### Supported Functions

- Video intercom: Built-in 2M pixel camera with microphone
- E-lock function: E-lock Connected to Door Station. Supports remote unlock from Mobile App or Room Monitors.
- Leave message: Visitors can leave voice message.
- Surveillance: Door Station video live-stream viewable on Room Monitors & Mobile Apps.
- Device Removal Alarm: When device is removed, alarm will be sounded, and alert will be sent.



#### Smartphone Connect:

Extend your hospitality and unlock doors remotely from anywhere inside or outside your home with your smartphone.



#### SOS Alert:

Each Room Monitor features an SOS button that instantly sends push notifications to your smartphone.



#### Voice Changer:

Maintain your security and privacy when answering calls from strangers with the voice changer feature.



#### Video Recording:

Every call is automatically recorded at the Room Monitor upon answering for your peace of mind.



#### Surveillance Features:

Feel in control over the safety of your home by accessing live IP Cameras using the Room Monitor.

### Features



Wi-Fi or Wired Connection



Smartphone Connect  
(\*Up to 6 mobile devices per residential unit.)



IP Camera Monitoring



Voice Changer



Auto Video + Audio Recording



PoE Powered



SOS One Touch

## IP VIDEO INTERCOM | SINGLE HOUSE CONFIGURATION & SYSTEM DIAGRAM

### Setup Flow (With Room Monitor)

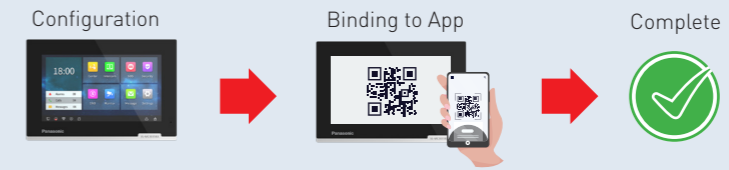

- STEP 1:** Configure at Room Monitor, Select Language > Search device list > Assign IP parameter (Auto/ Manual).  
**STEP 2:** Select device (1-by-1) from Room Monitor screen, then use APP to scan the QR code of each device shown in Room Monitor.

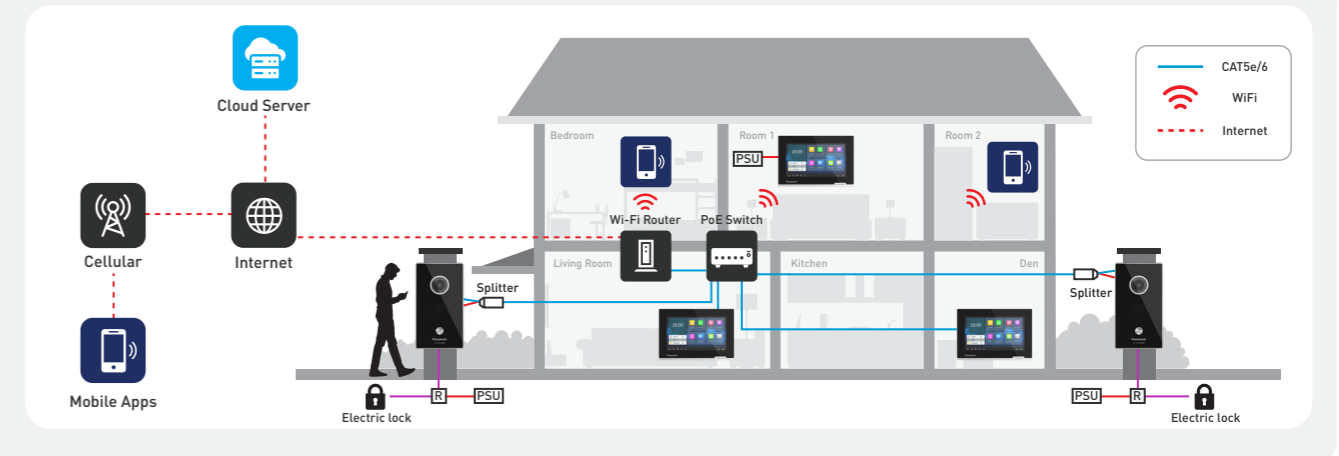

### Setup Flow (Without Room Monitor)

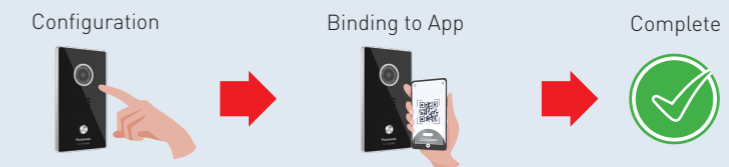

- STEP 1:** Add a new Door Station in the App, a QR Code will be generated in the App.  
**STEP 2:** Show the QR code displayed on the App to the Door Station's camera.

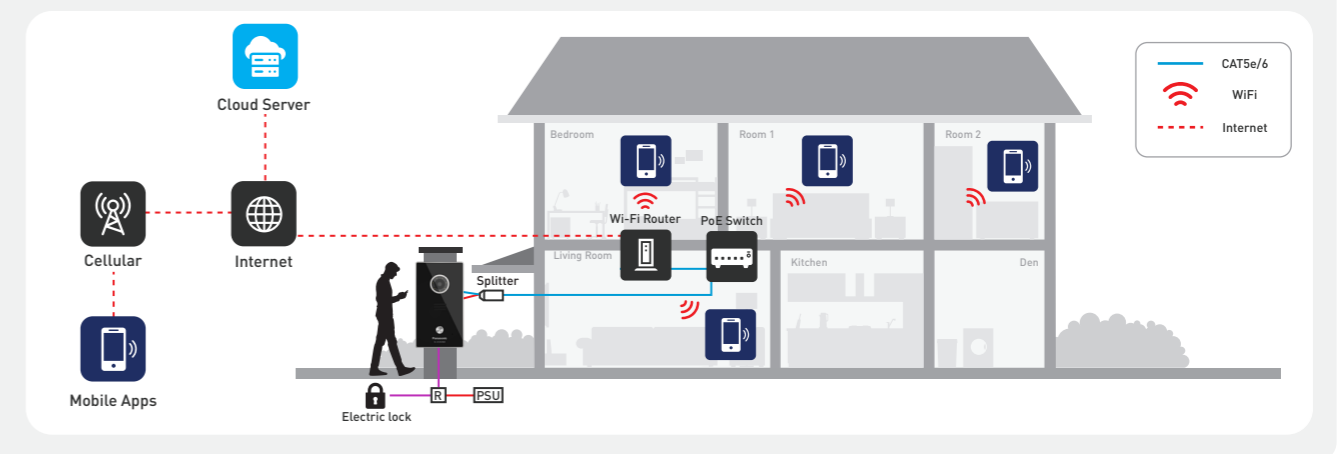

### SYSTEM UNITS

Room Monitor  
VL-VC3035BX/WX



Door Station  
VL-VC3535BX



Mobile APP "S.iCITY-VIC"

